

L-36 BLOWVALVE ASSEMBLY

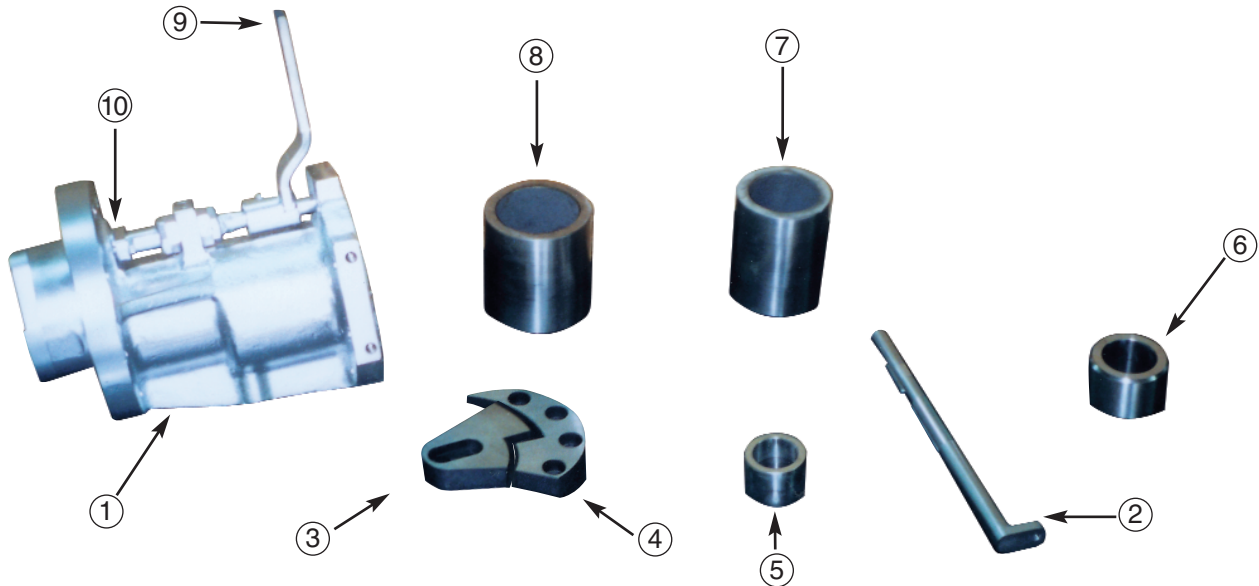

ITEM	PART DESCRIPTION	PART#
1	Housing	SDR-1071-36
2	Shaft	SDR-1106-36
3	Shutter	SDR-1099-36
4	Shutter Plate	SDR-1100-36
5	Nozzle Bushing	SDR-1096-36

ITEM	PART DESCRIPTION	PART#
6	Inner Liner	SDR-1093-36
7	Middle Liner	SDR-1094-36
8	Outer Liner	SDR-1095-36
9	Adjusting Arm	SDR-1107-36
10	Packing Gland	SDR-1105-36

Complete Blowvalve Assembly (including 1-10 above) SDR - 1171-36

- New, rebuilds, exchange blowvalve housings and assemblies
- Multiple size orifices available – 2.1, 2.6, 3.0 sq. in.
- D2 and 440 stainless standard alloys
- *for other alloys call for availability*
- All items listed are stock items

REFINER PRODUCTS MANUFACTURING, INC.

Main Office: P.O. Box 471335 • Charlotte, NC 28247 • Phone: 704.602.3070 • Fax: 704.602.3071
Shipping Address: 240 Seaboard Avenue • Johnsonville, SC 29555

L-42 THRU L-46 BLOWVALVE ASSEMBLY

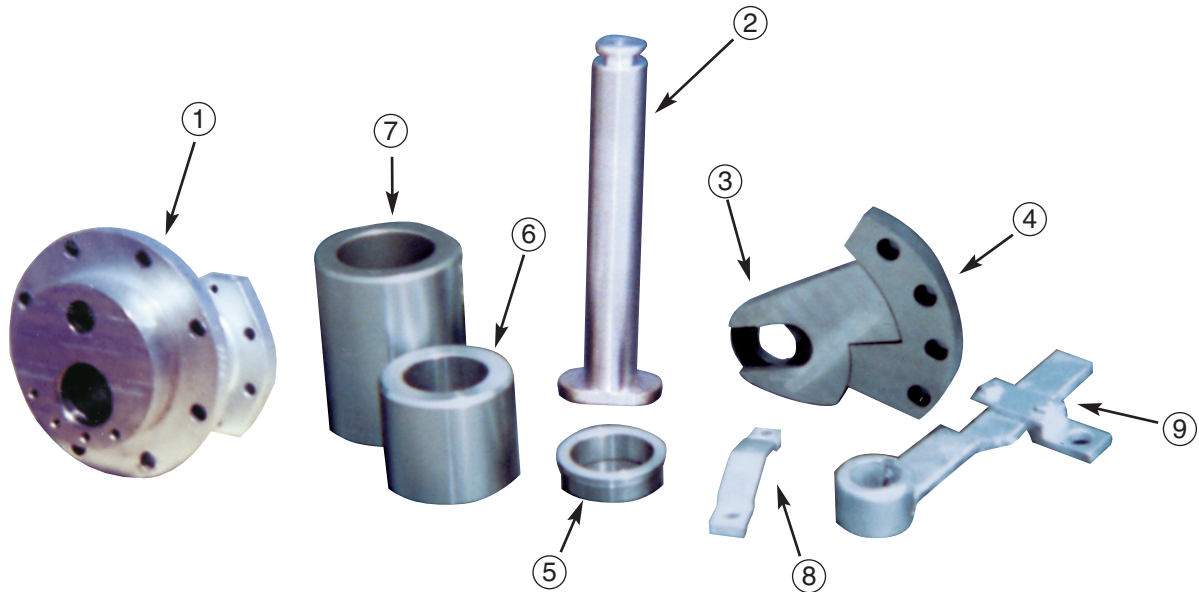

ITEM	PART DESCRIPTION	PART#
1	Housing	SDR-1070-42-46
2	Shaft	SDR-1309-42-46
3	Shutter	SDR-1088-42-46
4	Shutter Plate	SDR-1089-42-46
5	Nozzle Bushing	SDR-1342-42-46

ITEM	PART DESCRIPTION	PART#
6	Inner Liner	SDR-1200-42-46
7	Outer Liner	SDR-1201-42-46
8	Shaft Bracket	SDR-1324-42-46
9	Adjusting Arm	SDR-1325-42-46
10	Packing Gland	SDR-1326-42-46

Complete Blowvalve Assembly (including 1-10 above) SDR - 1077-42-46

- New, rebuilds, exchange blowvalve housings and assemblies
- Multiple size orifices available – 4.1, 4.5, 5.0 sq. in.
- D2 and 440 stainless standard alloys
- *for other alloys call for availability*
- All items listed are stock items

REFINER PRODUCTS MANUFACTURING, INC.

Main Office: P.O. Box 471335 • Charlotte, NC 28247 • Phone: 704.602.3070 • Fax: 704.602.3071
Shipping Address: 240 Seaboard Avenue • Johnsonville, SC 29555